



User Manual

HA011068

CONNECTION CABLE

YOUR PARTNER IN SENSOR TECHNOLOGY



ELEKTRONIK[®]
Ges.m.b.H.

E+E Elektronik Ges.m.b.H. does not accept warranty and liability claims neither upon this publication nor in case of improper treatment of the described products.

The document may contain technical inaccuracies and typographical errors. The content will be revised on a regular basis. These changes will be implemented in later versions. The described products can be improved and changed at any time without prior notice.

© Copyright E+E Elektronik Ges.m.b.H. All rights reserved.

CONTENT

| | | |
|----------|---|----------|
| 1 | General | 4 |
| 1.1 | Explanation of symbols | 4 |
| 1.2 | Safety instructions | 4 |
| 1.2.1 | General safety instructions | 4 |
| 1.3 | Environmental aspects | 4 |
| 2 | TECHNICAL DESCRIPTION | 5 |
| 2.1 | General..... | 5 |
| 3 | ELECTRICAL CONNECTIONS | 5 |
| 3.1 | PC connection | 6 |
| 3.2 | EE-PCS Product Configuration Software | 6 |
| 4 | ORDERING INFORMATION | 6 |
| 5 | TECHNICAL DATA | 6 |

1 GENERAL

This operation manual serves for ensuring proper handling and optimal functioning of the device. It shall be read before commissioning the equipment and it shall be provided to all staff involved in transport, installation, operation, maintenance and repair.

The operation manual may not be used for the purposes of competition without the written consent of E+E Elektronik® and may not be forwarded to third parties. Copies may be made for internal purposes. All information, technical data and diagrams included in the manual are based on the information available at the time of writing.

Disclaimer

The manufacturer cannot be held responsible for damages as a result of incorrect handling, installation and maintenance of the device. Unauthorized modifications of the product lead to loss of all warranty claims.

The manufacturer or his authorized agent can only be held liable in case of willful or gross negligence. In any case, the scope of liability is limited to the corresponding amount of the order issued to the manufacturer. The manufacturer assumes no liability for damages incurred due to failure to comply with the applicable regulations, operating instructions or the operating conditions. Consequential damages are excluded from the liability.

1.1 Explanation of Symbols



This symbol indicates instructions that must be observed in hazardous areas with risk of explosion.

1.2 General Safety Instructions

In the event of **improper** or **incorrect** use of the device, following may occur:

- Hazards for the device and other assets
- Hazards that impair the efficient operation of the device.

The following instructions shall be observed for safe operation:

Only qualified or specially trained staff may work on or operate the device.

These operating instructions shall always be available to all staff in charge with mounting, commissioning, operation and servicing.

It is essential that the device may only be used when in perfect operating condition.

Any device faults shall be immediately repaired by authorized staff or by E+E Elektronik customer service. No technical modifications to the device are permitted.

1.3 Environmental Aspects



Products from E+E Elektronik® are developed and manufactured observing of all relevant requirements with respect to environment protection. Please observe local regulations for the device disposal.

For disposal, the individual components of the device must be separated according to local recycling regulations. The electronics shall be disposed of correctly as electronics waste.

2 TECHNICAL DESCRIPTION

The connection cable HA011068, in combination with EE-PCA Product Configuration Adapter, is intended and certified for the configuration of the E+E intrinsically safe sensors.

The configuration may not be performed in the hazardous area (classified location)!

3 ELECTRICAL CONNECTIONS



It is essential that removal and reinstallation of the sensor to be configured in explosion hazard area are only carried out by trained specialist personnel authorized to do so by the system operator.



Disconnect all sensor wiring (4-20 mA), before connecting it to the connection cable HA011068.

For the configuration of the E+E sensors please refer to the corresponding operation manual.



The connection cable HA011068 and the EE-PCA may only be used for configuration in non-hazardous indoor area (unclassified area).

**Hazardous area
(Classified location)**

**Non-hazardous area
(Unclassified location)**

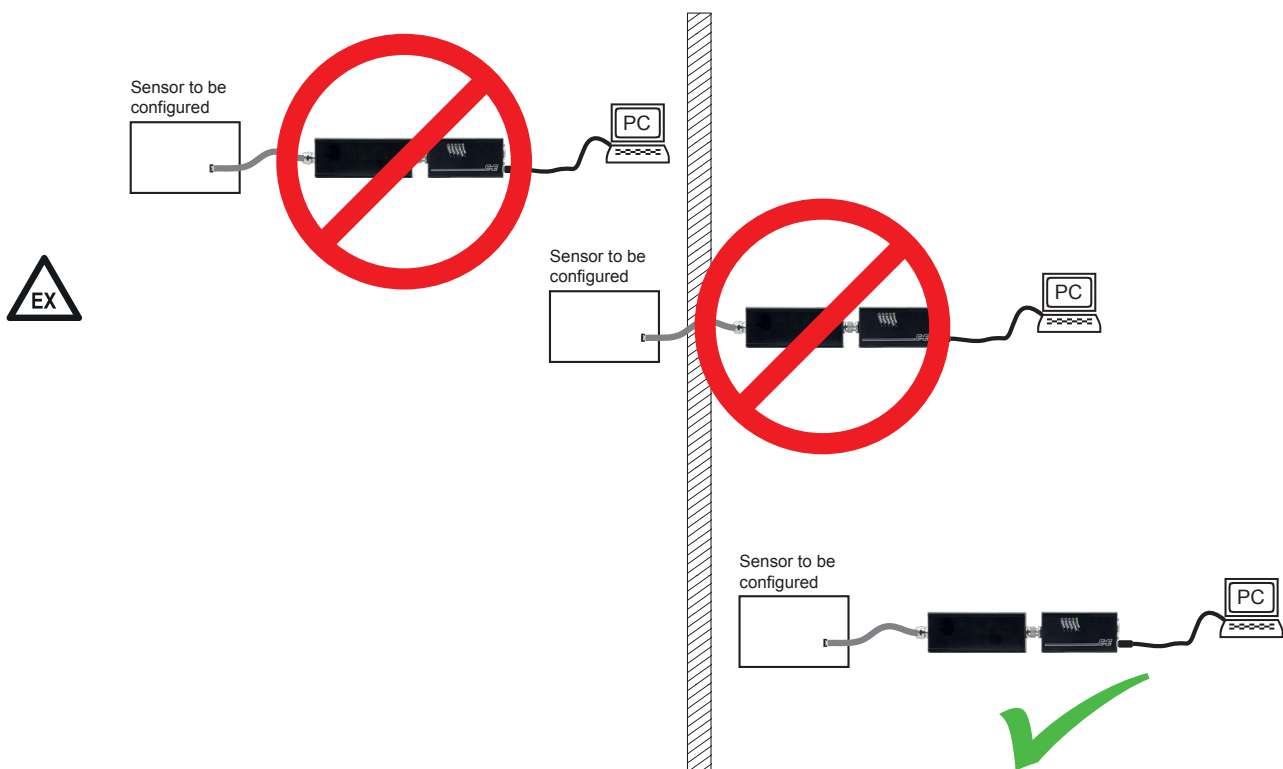

After configuration, make sure that the sensor is free of damages and of electrostatic charge before reinstalling it in the hazardous area.

It is not allowed to disassemble the connection cable HA011068.

3.1 PC Connection

- During the configuration procedure, the sensors are supplied by the EE-PCA and the connection cable HA011068. Do not connect any other power supply to the sensors!
- Connect the EE-PCA to the USB or the RS232 port of the PC. Using the RS232 port, the EE-PCA requires external supply voltage. Use the power supply adapter included in the scope of supply.
- Connect the EE-PCA to the connection cable HA011068.
- Connect the connection cable HA011068 to configuration interface of the sensor (the 4 pins blue connector on the electronic board).

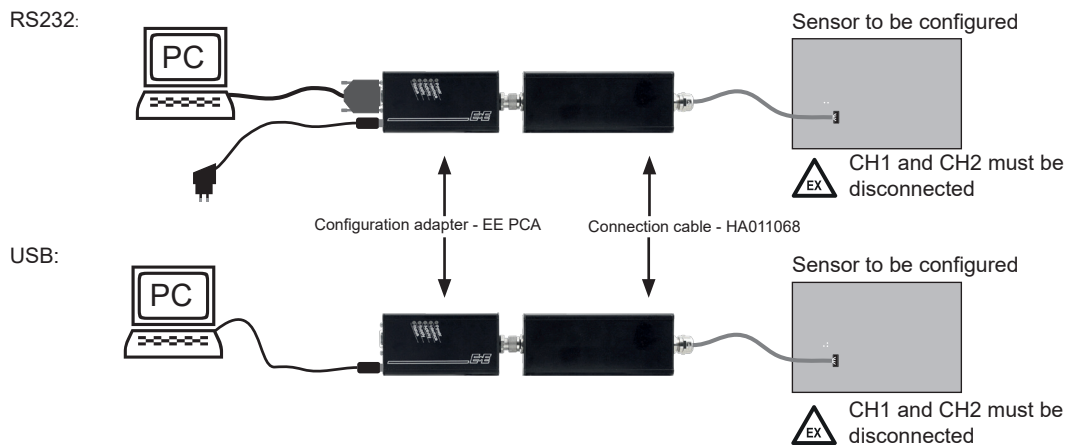

3.2 EE-PCS Product Configuration Software

1. Download the EE-PCS Product Configuration Software from www.epluse.com/configurator and install it on the PC.
2. Connect the E+E sensor to the PC using the connection cable.
3. Start the EE-PCS software.
4. Follow the instructions on the EE-PCS opening page for scanning the ports and identifying the connected device.
5. Click on the desired setup or adjustment mode from the main EE-PCS menu on the left and follow the online instructions of the EE-PCS

4 ORDERING INFORMATION

Designation Order code (see datasheet EE-PCA):

Ordering code

EE-PCA
HA011068

Description

Product Configuration Adapter, for connection to the PC
Connection cable with protective circuitry between the E+E sensors and the EE-PCA

5 TECHNICAL DATA

| | |
|-------------------------------|---|
| Supply voltage: | 5 V (from external power supply or via USB port) |
| Communication Interface: | USB or RS232 |
| Software system requirements: | WINDOWS XP or higher |
| Enclosure Protection class: | IP20 |
| Temperature range: | -40...40 °C (-40...104 °F) |
| Storage range: | Temperature: -40...60°C (-40...140°F) Humidity: 10...70 % RH |
| Installation altitude: | up to 2.000 m above sea level |
| Application: | indoor in dry and clean environment |
| Pollution degree: | 2 |



HEADQUARTERS

E+E Elektronik Ges.m.b.H.

Langwiesen 7
A-4209 Engerwitzdorf
Austria
Tel: +43 7235 605 0
Fax: +43 7235 605 8
info@epluse.com
www.epluse.com

SUBSIDIARIES

E+E Elektronik Germany

info@epluse.de

Office Bad Homburg
Tel: +49 6172 13881-0

Office Hamburg
Tel: +49 160 9050 6460

Office Stuttgart
Tel: +49 151 538 37 500

E+E Elektronik Italy

info@epluse.it
Tel: +39 02 2707 86 36

E+E Elektronik France

info@epluse.fr
Tel: +33 4 74 72 35 82

E+E Elektronik USA

office@epluse.com

Office Boston
Tel: +1 847 490 0520

Office Chicago
Tel: +1 847 490 0520

E+E Elektronik Korea

Tel: +82 31 732 6050
info@epluse.co.kr

E+E Elektronik China

info@epluse.cn

Office Beijing
Tel: +86 10 8499 2361

Office Shanghai
Tel: +86 21 6117 6129

Office Guangzhou
Tel: +86 20 3898 7052

YOUR PARTNER IN SENSOR TECHNOLOGY



ELEKTRONIK®
Ges.m.b.H.