

QUICK GUIDE

For manual see www.epluse.com/EE671

EE671 - HVAC Miniature Air Flow Transmitter

WIRING

Supply voltage: 10...29 V DC SELV

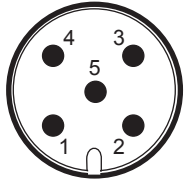

view on sensor plug

| Plug version | Cable version | Analog output | Modbus RTU output |
|--------------|---------------|----------------------------------|---------------------|
| 1 | grau | SDA (digital setup interface E2) | V+ = Supply voltage |
| 2 | braun | GND | RS485-B (=D-) |
| 3 | grün | AV = Analog output | RS485-A (=D+) |
| 4 | gelb | SCL (digital setup interface E2) | GND |
| 5 | weis | V+ = Supply voltage | n.c. |

Accessory HA0108xx - connecting cable



| | | | Analog output | Modbus RTU output |
|---|--|----|----------------------------------|---------------------|
| 1 | | BN | SDA (digital setup interface E2) | V+ = Supply voltage |
| 2 | | WH | GND | RS485-B (=D-) |
| 3 | | BU | AV = Analog output | RS485-A (=D+) |
| 4 | | BK | SCL (digital setup interface E2) | GND |
| 5 | | GY | V+ = Supply voltage | n.c. |

Modbus RTU

The EE671 air flow transmitter can be operated in a Modbus RTU network with max. 32 devices. For Modbus protocol settings see Application Note Modbus AN0103 (www.epluse.com/EE671).

The factory setting for the Slave-ID is 238 as an integer 16Bit value.

This ID can be customised in the register 0x00 (value margin 1 - 247 permitted).

| Register [DEC] | Protocol address [HEX] | Measured value | Unit | Type |
|--|------------------------|-------------------------|-------------|----------------|
| Read registers (function code 0x03 / 0x04) | | | | |
| 30001 | 0x00 | Serial number | | ASCII |
| 30009 | 0x08 | Software version | | Binary |
| 30010 | 0x09 | Transmitter name | | ASCII |
| 30026 | 0x19 | Temperature | °C | 32-bit float |
| 30028 | 0x1B | Temperature | °F | 32-bit float |
| 30030 | 0x1D | Temperature | K | 32-bit float |
| 30032 | 0x1F | Air velocity | m/s | 32-bit float |
| 30034 | 0x21 | Air velocity | ft/min | 32-bit float |
| 30046 | 0x2D | Temperature | °C x 100 | 16-bit integer |
| 30047 | 0x2E | Temperature | °F x 100 | 16-bit integer |
| 30048 | 0x2F | Temperature | K x 100 | 16-bit integer |
| 30049 | 0x30 | Air velocity | m/s x 100 | 16-bit integer |
| 30050 | 0x31 | Air velocity | ft/min x 10 | 16-bit integer |
| Write registers (function code 0x06) | | | | |
| 60001 | 0x00 | Network address | | |
| 60002 | 0x01 | Communication parameter | | |

Bore hole for mounting

drilling in the wall of the duct:

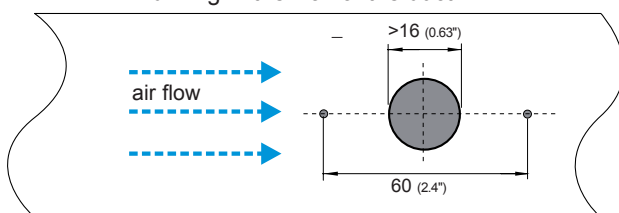

optional (laser cutting):

hole in the wall of the duct:

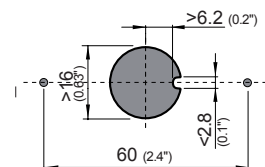

By leaving a key notch in the hole in the wall of the duct, the flange can be mounted in the correct direction of the air stream.